

SYCAMORE

Installation instructions : SY9057 6W LED Dimmable Fire Rated IP65 Downlight

Thank you for purchasing this SycamoreLED.com product. Please make sure instructions are followed carefully prior to and during installation and product is not altered, otherwise warranty may not be valid. For technical support or warranty information please visit www.sycamoreLED.com, or call our dedicated technical helpline +44 (0) 113 2866686.

IMPORTANT—Please read prior to installation

- 1) Please read these instructions carefully before commencing any work
- 2) Please retain these instructions for future reference
- 3) **This unit must be installed by a qualified electrician in accordance with the IEE wiring regulations and building regulations**
- 4) To prevent electrocution switch the power off at the mains supply before installing or maintaining this fitting
- 5) Ensure others cannot restore the electrical supply without your knowledge

SPECIFICATION & DIAGRAMS

THE TECHNICAL SPEC...	
Fitting Type	Dimmable LED, IP65, Fire rated for 30, 60 & 90 minute
Finish	White. Chrome, Nickel and Matt Black Bezel Available
Cut Out	68mm
IP Rating	IP65
Lamp Life	50,000 hours
Colour Temperature	Switchable
Wattage	6W

-20°C < Ta < +40°C, 220-240V ~ 50/60Hz, Class I , IP65 Suitable for mounting on a normally flammable surface. Dimmable with selected leading and trailing edge dimmers

The luminaire may be covered with mineral wool thermal insulation or glass wool thermal insulation of the type described in EN 13162:2015. This applies to both solid and blow over loose fill. If the installer wishes to use cellulose based loose insulation or foam spray over insulation, they must use a bell-shaped insulation cover over the luminaire. Although the fitting may be safely covered with insulation material, we recommend that the luminaire be abutted to but not covered with insulation material in order to maximise the lifetime of the luminaire. Luminaire lifetime can be maximised by maintaining as low an operating temperature as possible

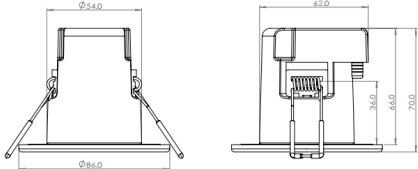

INSTALLATION INSTRUCTIONS

- 1) Ensure the downlight will fit into the ceiling joist, avoiding obstructions.
- 2) Cut a 68mm diameter hole in the required location. Note—this fitting is suitable to be covered with insulation material
- 3) Feed the power supply cable through the hole.
- 4) Connect the supply cable(s) to the push fit terminals, observing correct polarity. Close the cover to retain the cable(s).
- 5) Pass the supply cable through the ceiling aperture. Push up the spring clips and offer up the downlight into the ceiling until it sits flush and in position.
- 6) Replace the bezel trim. Align the lugs on the bezel with the cut outs on the body. Push and rotate clockwise until the bezel locks into position (approx. 1/3 turn).
- 7) Restore the power and check for correct operations.

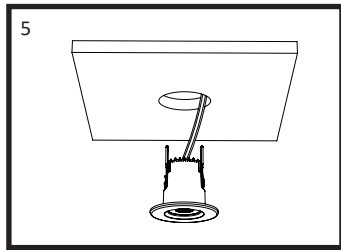
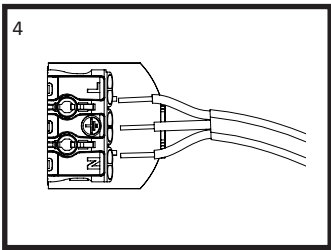
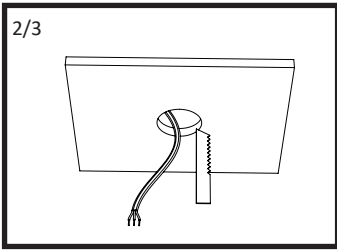

BEZEL REPLACEMENT

The SY9057 comes in a White finish as standard, you can purchase a replacement bezel in either Polished Chrome (SY9051CC), Brushed Nickel (SY9051BN), or Matt Black (SY9051BL).

- 1) Remove existing bezel by rotating it anti-clockwise until it releases from the body., Replace the desired bezel trim. Align the lugs on the bezel with the cut outs on the body. Push and rotate clockwise until the bezel locks into position (approx. 1/3 turn).

DIMMABLE LUMINAIRE

SY9057 is dimmable with many Triac Leading and Trailing edge dimmer switches and dimming systems.

Recommended Dimmers:

- Non-Electronic Leading Edge: Shneider/GET/Danlers/BG/Varilight/Deta/Zano/Emco
- Electronic Dimmers: Wireless Kinetic Receiver SY8989NEW & Switches SY8990—SY8992
- Do not exceed ¼ Of dimmer capacity. (e.g. for 400W dimmers, do not exceed 100W).

Do not carry out high voltage insulation testing with this luminaire connected as it will damage the driver.

CARE IN USE

- 1) Please note this fitting has non replaceable parts
- 2) Always switch off or disconnect from the mains when cleaning the product.
- 3) We recommend cleaning with a soft dry cloth. Do not use scourers, abrasives or chemical cleaners.
- 4) Do not allow moisture to come into contact with electrical parts
- 5) This luminaire should not be disposed of with normal household rubbish. When a replacement is purchased, this luminaire should be returned to the retailer to safely dispose of (WEEE Directive effective July 2006—Waste from Electrical & Electronic Equipment)

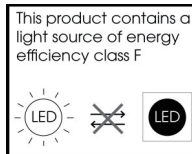

SycamoreLED.com
LS25 2DY
Technical helpline : 0113 2866686
*Please email sales@sycamoreled.com to register your product

